

# PART# 400

## Steel Brackets Light Weight

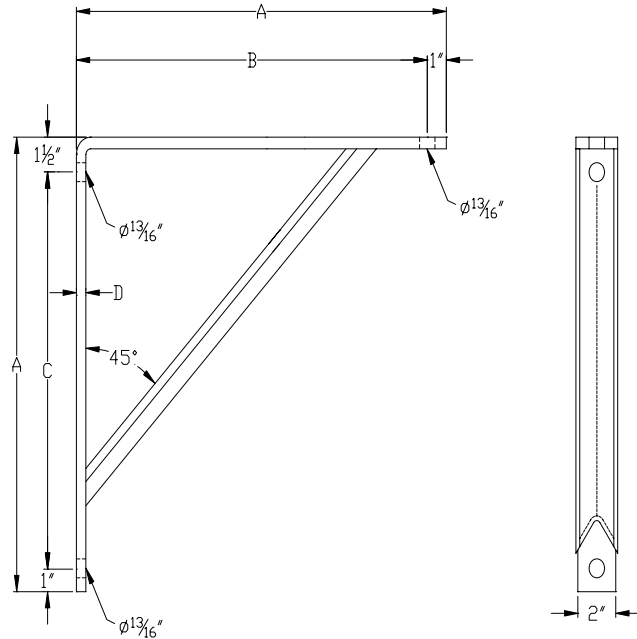

**MAXIMUM LOAD:** 750 pounds.

**MATERIAL:** Carbon steel bracket.

**FINISH:** Black, Galvanized, or coated to customer specifications.

**SERVICE:** Recommended for support from below.

**APPROVALS:** Complies with Manufacturers Standardization Society SP-69 (Type 31)

**ORDERING:** Specify bracket number, part number, name, and finish. Order hanger rods and hex nuts separately.

### Load (lbs) • Weight (lbs) • Dimensions (inches)

Bracket no.	Maximum Load	Weight	A	B	C	D
1	750	3.1	9	8	6 1/2	5/16
2	750	7.7	13	12	10 1/2	5/16
3	750	12.8	19	18	16 1/2	3/8